

# Terminations & Loads



## Models 1458 Medium Power, 3.5mm Connectors Conduction Cooled

dc to 22.0 GHz  
50 Watts



### Features

- /// **Compact Construction** - Lowest size/power ratio.
- /// **Rugged Construction** - Quality connector with special high temperature support bead.

### Specifications

**NOMINAL IMPEDANCE:** 50  $\Omega$

**FREQUENCY RANGE:** dc to 22.0 GHz

#### MAXIMUM SWR:

| Frequency (GHz) | SWR  |
|-----------------|------|
| dc - 22.0       | 1.30 |

**POWER RATING:** 50 watts **average**, 1 kilowatts **peak** (5  $\mu$ sec pulse width; 2.5% duty cycle) with case temperature held within **90°C maximum** with appropriate conductive heatsink.

**TEMPERATURE RANGE:** -55°C to 90°C case.

**TEST DATA:** Swept data plots of SWR from 50 MHz to 22 GHz is available at additional cost.

**CONNECTOR:** 3.5mm connectors - mate nondestructively with SMA per MIL-C-39012, 2.92mm, and other 3.5mm connectors. Choice of male (-2) or female connector (-1).

**CONSTRUCTION:** Aluminum alloy body, stainless steel connector; gold plated beryllium copper contacts.

**WEIGHT:** Net 56 g (1.9 oz) maximum

### PHYSICAL DIMENSIONS:

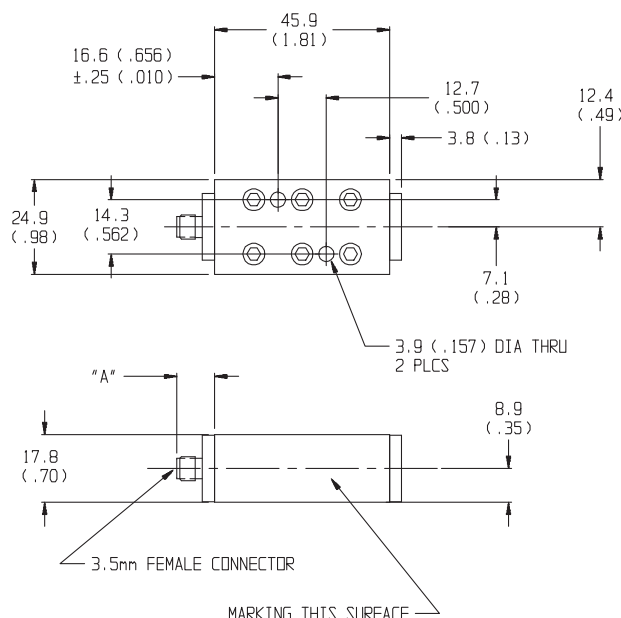

| Model # | DIM A                | Connector Type |
|---------|----------------------|----------------|
| 1458-1  | 9.9±0.5 (0.35±0.02)  | 3.5mm female   |
| 1458-2  | 13.4±0.5 (0.53±0.02) | 3.5mm male     |

**NOTE:** All dimensions are given in mm (inches) and are maximum, unless otherwise specified.