

TERMINATIONS TYPE N

DC - 18 GHz 5 WATTS



MODELS: TNXXXM-5W, TNXXXF-5W

SPECIFICATIONS:

Electrical:

Frequency Range _____ DC - 18 GHz
 Standard Freq. Values _____ 6, 12.4 & 18 GHz
 VSWR
 DC - 4 GHz _____ 1.10:1 Max.
 4 - 8 GHz _____ 1.15:1 Max.
 8 - 12.4 GHz _____ 1.20:1 Max.
 12.4 - 18 GHz _____ 1.25:1 Max.
 Impedance _____ 50 Ohms
 Input Power _____ 5 Watts Avg. @ +25°C
 _____ Derated Linearly to 1 Watt @ +125°C
 Operating Temp Range _____ -65°C to +125°C

Mechanical:

Type N Connectors _____ Passivated Stainless Steel
Mates with MIL-STD-348
 Housing _____ Anodized Aluminum
 Conductors _____ Gold Plated Beryllium Copper



Model Number: **TNXXXM-5W**
 Type N Male Connector

Model Number: **TNXXXF-5W**
 Type N Female Connector

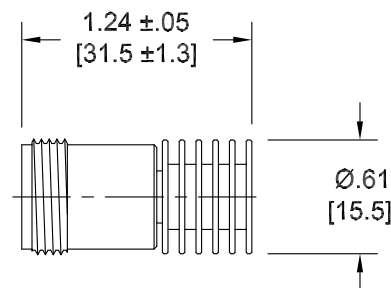
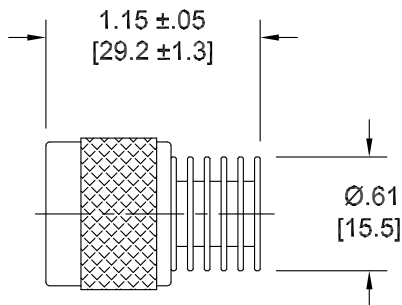

HOW TO ORDER:

Model Number: **TNXXXY-5W**
 Frequency Range | Connector Configuration
 060 = DC - 6 GHz M = Male
 120 = DC - 12.4 GHz F = Female
 180 = DC - 18 GHz

Ordering Examples:

Model Number: **TN120M-5W**
 DC - 12.4 GHz; Type N Male

Model Number: **TN060F-5W**
 DC - 6 GHz; Type N Female

Model Number: **TN180M-5W**
 DC - 18 GHz; Type N Male

Note: Dimensions in Brackets are Expressed in Millimeters and are for Reference Only.

Design specifications are subject to change without notice.

Contact factory for technical specifications before purchasing or use.

TN180-5W; REV G