

DC BLOCKS
2.4mm to 2.9mm

10 MHz to 40 GHz
200 VOLTS



MODELS: 8306, 8309 & 8180

SPECIFICATIONS:

Electrical:

Frequency Range _____ 10 MHz – 40 GHz
 VSWR:
 10 MHz – 23 GHz _____ 1.45:1 Max.
 23 – 40 GHz _____ 1.75:1 Max.
 Impedance _____ 50 Ohms
 Insertion Loss:
 10 MHz – 23 GHz _____ 0.75dB Max.
 23 – 40 GHz _____ 1.25dB Max.
 Voltage Rating _____ 200 Volts Max.
 Operating Temp. Range _____ -65°C to +125°C

Mechanical:

2.4mm Connectors _____ Passivated Stainless Steel
 (Mates with 1.85mm & V* Connectors)
 2.9mm Connectors _____ Passivated Stainless Steel
 (Mate both Mechanically & Electrically with
 all SMA, K* & 3.5mm Series Connectors.)
 Conductors _____ Gold Plated Beryllium Copper

* K & V are trademarks of Anritsu/Wiltron Corp.



Model Number: **8306**
 2.9mm Female / 2.4mm Male

Model Number: **8309**
 2.9mm Male / 2.4mm Female

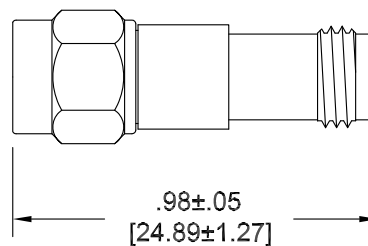
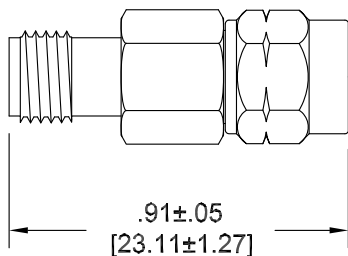

Model Number: **8180**
 2.9mm Female / 2.4mm Female

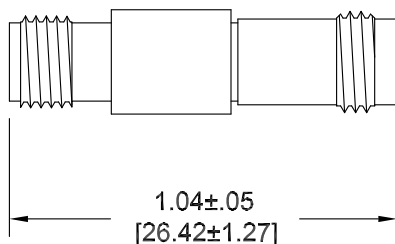

Note: Dimensions in Brackets are Expressed in Millimeters and are for Reference Only.
 Design specifications are subject to change without notice.
 Contact factory for technical specifications before purchasing or use.