

**DC BLOCKS**  
**2.9mm**

**10 MHz - 26.5 GHz**  
**200 VOLTS**



MODELS: 8062A

SPECIFICATIONS:

*Electrical:*

Frequency Range \_\_\_\_\_ 10 MHz – 26.5 GHz  
VSWR \_\_\_\_\_ 1.35:1 Max.  
Impedance \_\_\_\_\_ 50 Ohms  
Insertion Loss \_\_\_\_\_ 0.75 dB Max.  
Voltage Rating \_\_\_\_\_ 200 Volts Max.  
Operating Temp. Range \_\_\_\_\_ -65°C to +125°C

*Mechanical:*

Connectors \_\_\_\_\_ Passivated Stainless Steel  
(Mate both Mechanically & Electrically with  
all SMA, K\* & 3.5mm Series Connectors.)  
Conductors \_\_\_\_\_ Gold Plated Beryllium Copper  
Housing \_\_\_\_\_ High Temperature Plastic  
Weight \_\_\_\_\_ 5.5 Grams Max.

\* K is a trademark of Wiltron Corp.

Model Number: **8062A**  
Inner / Outer

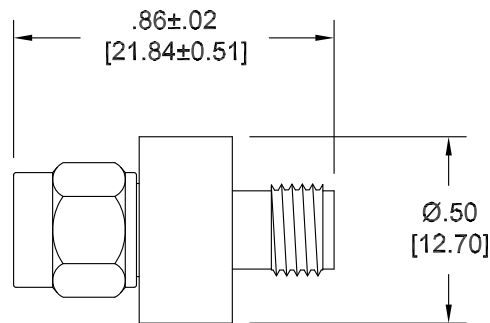

Note: Dimensions in Brackets are Expressed in Millimeters and are for Reference Only.  
Design specifications are subject to change without notice.  
Contact factory for technical specifications before purchasing or use.