

# ADAPTERS, IN-SERIES 2.9mm

## DC - 26.5 & 40 GHz



MODELS: 5160, 5161, 5162, 5170, 5171, 5172

### SPECIFICATIONS:

**Electrical:**

Frequency Range \_\_\_\_\_ See Below  
 VSWR  
 DC - 18 GHz \_\_\_\_\_ 1.10:1 Max.  
 18 - 26.5 GHz \_\_\_\_\_ 1.15:1 Max.  
 26.5 - 40 GHz \_\_\_\_\_ 1.25:1 Max.  
 Impedance \_\_\_\_\_ 50 Ohms  
 Operating Temp Range \_\_\_\_\_ -65°C to +125°C

**Mechanical:**

Connectors \_\_\_\_\_ Passivated Stainless Steel  
 (Mate both Mechanically & Electrically with  
 all SMA, K\* & 3.5mm Series Connectors.)  
 Conductors \_\_\_\_\_ Gold Plated Beryllium Copper

\* K is a trademark of Wiltron Corp.



Model Number: **5162**  
 Frequency Range \_\_\_\_\_ DC - 26.5 GHz  
 Male/Female Connectors

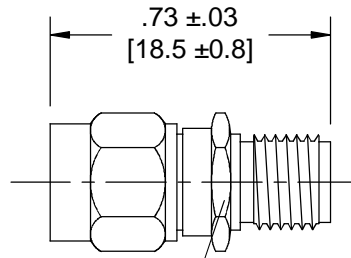

Model Number: **5172**  
 Frequency Range \_\_\_\_\_ DC - 40 GHz  
 Male/Female Connectors

5/16 [7.9] HEX

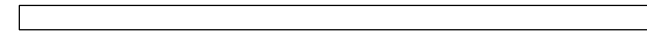

Model Number: **5161**  
 Frequency Range \_\_\_\_\_ DC - 26.5 GHz  
 Male/Male Connectors

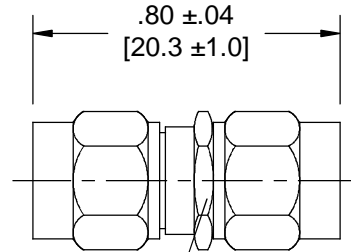

5/16 [7.9] HEX

Model Number: **5171**  
 Frequency Range \_\_\_\_\_ DC - 40 GHz  
 Male/Male Connectors



Model Number: **5160**  
 Frequency Range \_\_\_\_\_ DC - 26.5 GHz  
 Female/Female Connectors

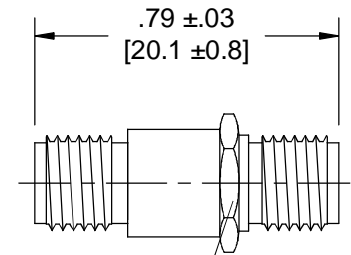

5/16 [7.9] HEX

Model Number: **5170**  
 Frequency Range \_\_\_\_\_ DC - 40 GHz  
 Female/Female Connectors

Note: Dimensions in Brackets are Expressed in Millimeters and are for Reference Only.  
 Design specifications are subject to change without notice.  
 Contact factory for technical specifications before purchasing or use.

5162; REV H