

ADAPTERS, BETWEEN SERIES BNC / SMA

DC - 8 GHz



MODELS: 5011, 5012, 5013, 5014

SPECIFICATIONS:

Electrical:

Frequency Range _____ DC – 8 GHz
VSWR _____ 1.25:1 Max.
Impedance _____ 50 Ohms
Operating Temp. Range _____ -65°C to +125°C

Mechanical:

SMA Connectors _____ Passivated Stainless Steel
Mates with MIL-STD-348
BNC Connectors _____ Nickel Plated Brass
Mates with MIL-STD-348
Conductors _____ Gold Plated Beryllium Copper

Model Number: **5011**
BNC Male / SMA Male

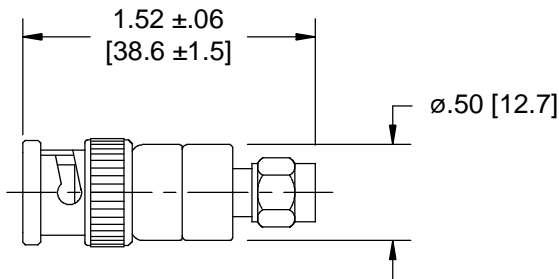

Model Number: **5013**
BNC Male / SMA Female

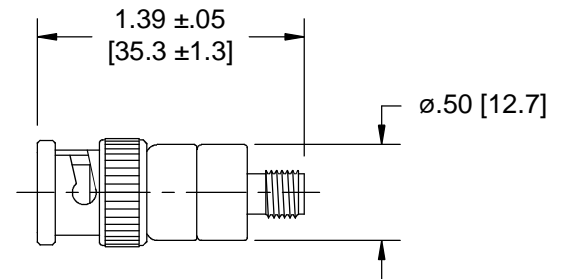

Model Number: **5012**
BNC Female / SMA Male

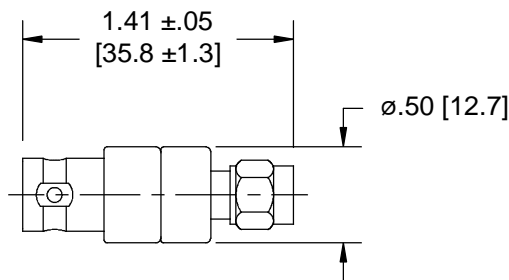

Model Number: **5014**
BNC Female / SMA Female

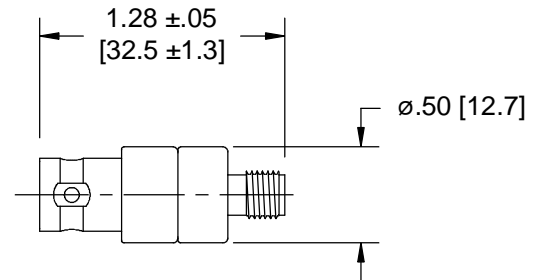

Note: Dimensions in Brackets are Expressed in Millimeters and are for Reference Only.
Design specifications are subject to change without notice.
Contact factory for technical specifications before purchasing or use.