

MIL-STD-461 Modular Power Filter

High performance, high-reliability, configurable catalog EMI filter for where SWaP-C is a critical factor.

Features

- High-frequency attenuation up to 1 GHz common mode
- Convenient input interface
- Configurable to maximize performance for the space available
- Compact design, up to 30% space saving size
- Environmentally sealed input interface

Applications

- Communication
- Navigation
- Lighting
- Threat detection
- Fuel systems
- Flight control
- Engine controls

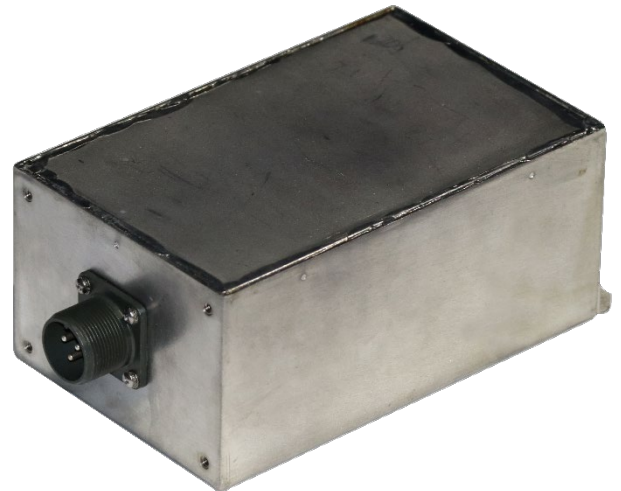

Electrical Specifications

Part Number	IL Performance	Current (Amps)	Voltage	Frequency	Operating Temp.
52-1836-105	Standard	5	250VAC	50-400Hz	-55 to +75°C
52-1836-110	Standard	10	250VAC	50-400Hz	-55 to +75°C
52-1836-115	Standard	15	250VAC	50-400Hz	-55 to +75°C
52-1836-205	Elite	5	250VAC	50-400Hz	-55 to +75°C
52-1836-210	Elite	10	250VAC	50-400Hz	-55 to +75°C
52-1836-215	Elite	15	250VAC	50-400Hz	-55 to +75°C

MIL-STD-461 Modular Power Filter

High performance, high-reliability, configurable catalog EMI filter for where SWaP-C is a critical factor.

Mechanical Layout

Part Number: 52-1836-X05 – 5A Rated

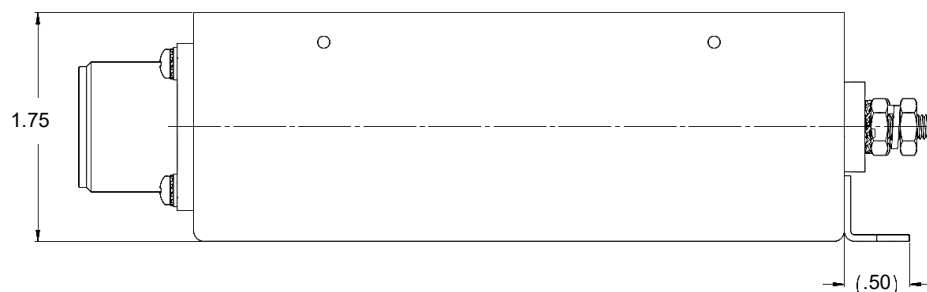
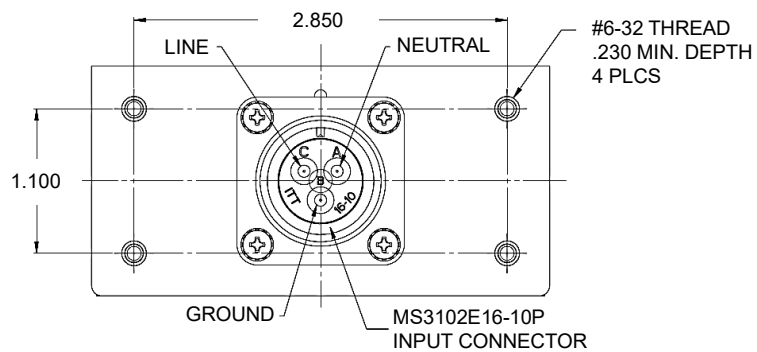
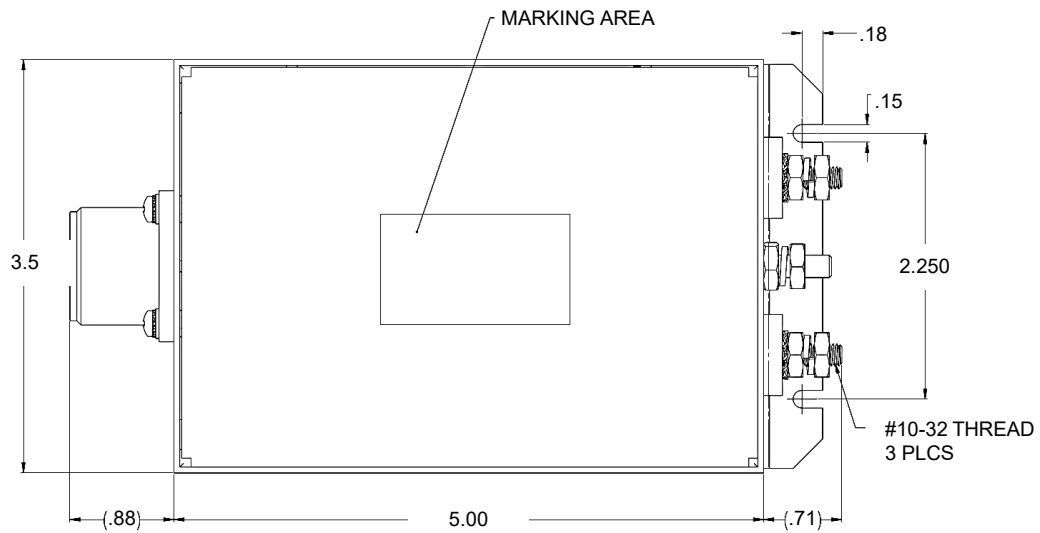

MIL-STD-461 Modular Power Filter

High performance, high-reliability, configurable catalog EMI filter for where SWaP-C is a critical factor.

Insertion Loss

Part Number: 52-1836-X05 – 5A Rated

Typical Common Mode Insertion Loss (No Load)

Frequency (MHz)	0.01	0.05	0.1	0.5	1	10	1000
52-1836-105 (dB)	13	27	34	60	60	60	60
52-1836-205 (dB)	10	25	25	75	85	85	80

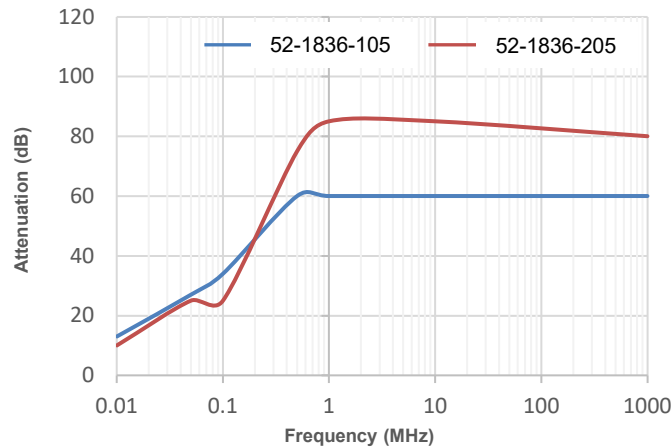

Typical Differential Mode Insertion Loss (No Load)

Frequency (MHz)	0.01	0.05	0.1	0.5	1	10
52-1836-105 (dB)	10	35	45	65	65	60
52-1836-205 (dB)	10	45	85	85	90	85

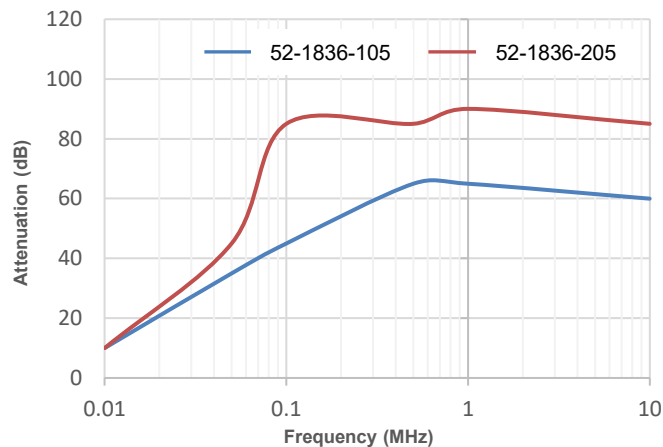

MIL-STD-461 Modular Power Filter

High performance, high-reliability, configurable catalog EMI filter for where SWaP-C is a critical factor.

Mechanical Layout

Part Number: 52-1836-X10 – 10A Rated

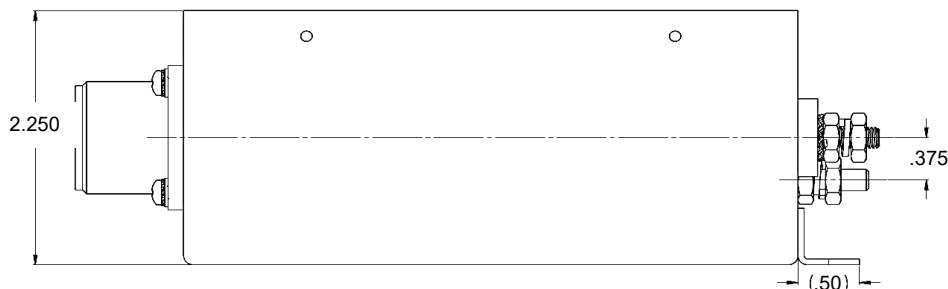
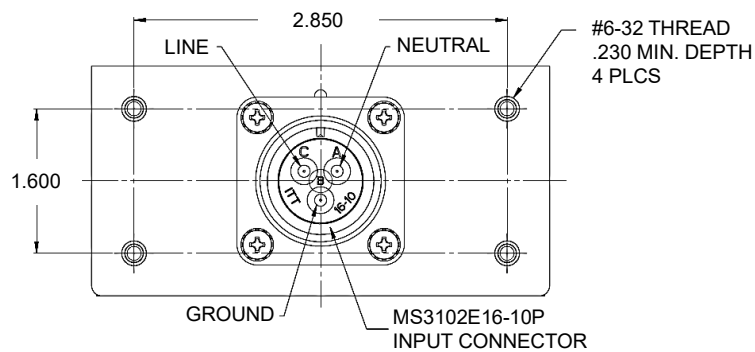
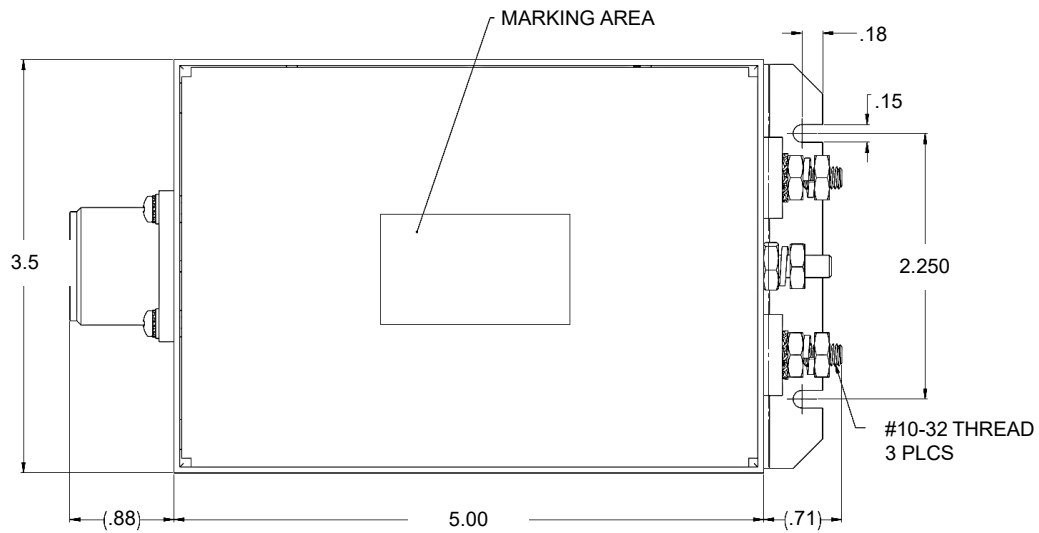

MIL-STD-461 Modular Power Filter

High performance, high-reliability, configurable catalog EMI filter for where SWaP-C is a critical factor.

Insertion Loss

Part Number: 52-1836-X10 – 10A Rated

Typical Common Mode Insertion Loss (No Load)

Frequency (MHz)	0.01	0.05	0.1	0.5	1	10	1000
52-1836-110 (dB)	10	25	35	35	60	60	60
52-1836-210 (dB)	10	20	25	70	80	65	65

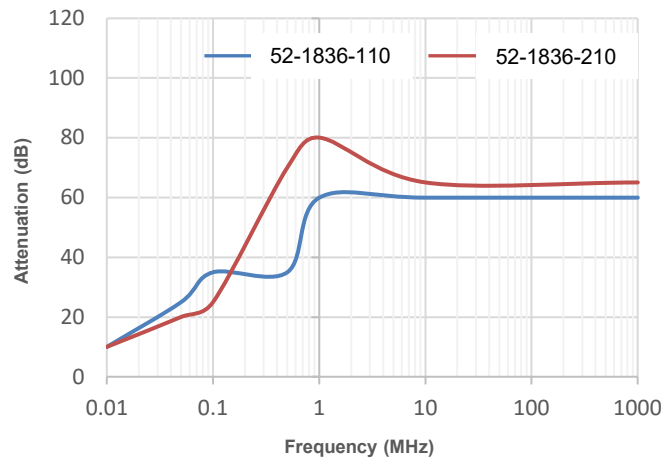

Typical Differential Mode Insertion Loss (No Load)

Frequency (MHz)	0.01	0.05	0.1	0.5	1	10
52-1836-110 (dB)	10	35	45	65	65	60
52-1836-210 (dB)	10	55	90	90	100	80

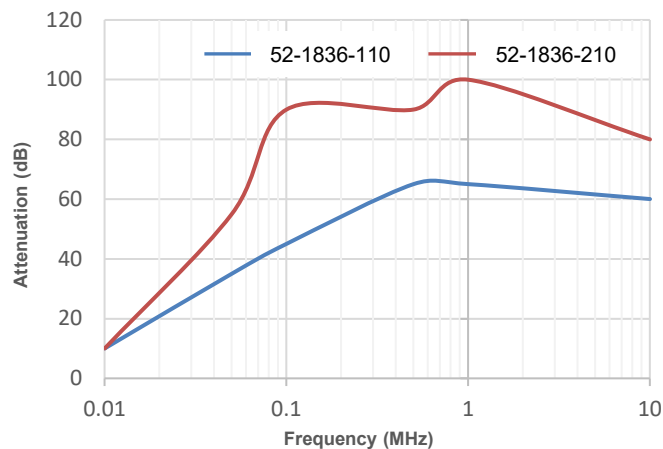

MIL-STD-461 Modular Power Filter

High performance, high-reliability, configurable catalog EMI filter for where SWaP-C is a critical factor.

Mechanical Layout

Part Number: 52-1836-X15 – 15A Rated

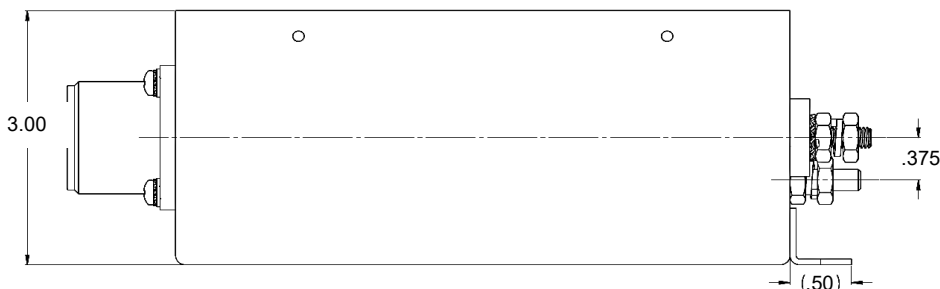
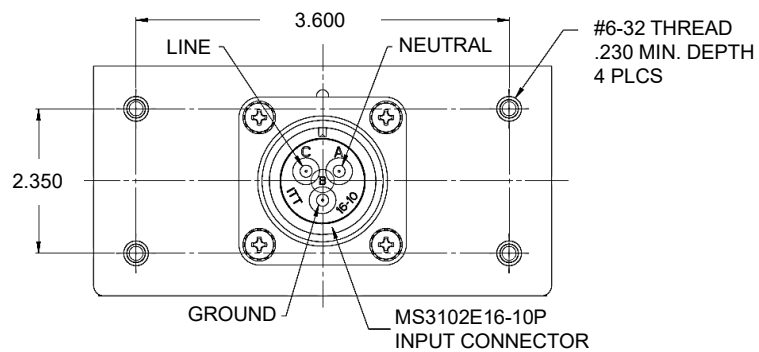
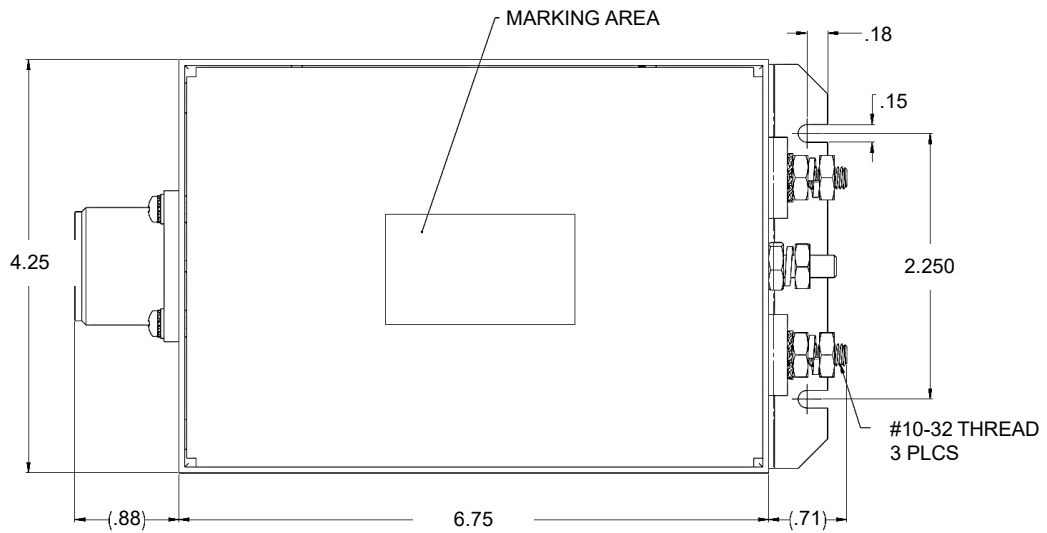

MIL-STD-461 Modular Power Filter

High performance, high-reliability, configurable catalog EMI filter for where SWaP-C is a critical factor.

Insertion Loss

Part Number: 52-1836-X15 – 15A Rated

Typical Common Mode Insertion Loss (No Load)

Frequency (MHz)	0.01	0.05	0.1	0.5	1	10	1000
52-1836-115 (dB)	10	25	30	30	45	45	60
52-1836-215 (dB)	10	25	30	30	65	65	65

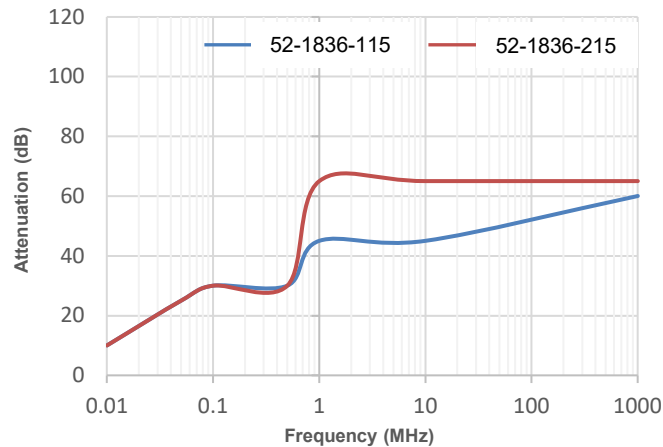

Typical Differential Mode Insertion Loss (No Load)

Frequency (MHz)	0.01	0.05	0.1	0.5	1	10
52-1836-115 (dB)	10	35	48	70	70	45
52-1836-215 (dB)	10	45	90	100	100	80

