

Termination, 1.85mm

Model TV650F-1W & TV650M-1W

Frequency Range: DC to 65.0 GHz
Power: 1 Watts

Features

- Millimeter Wave Termination
- Suitable for use in Military Applications
- Economically priced for Commercial Applications
- Mates with 1.85mm and 2.4mm Connectors

Technical Specifications

Parameter	Value						
Frequency Range	DC to 65 GHz						
VSWR	<table border="0"> <tr> <td>DC - 10 GHz</td> <td>1.20:1 Max.</td> </tr> <tr> <td>10 - 30 GHz</td> <td>1.40:1 Max</td> </tr> <tr> <td>30 - 65 GHz</td> <td>1.55:1 Max.</td> </tr> </table>	DC - 10 GHz	1.20:1 Max.	10 - 30 GHz	1.40:1 Max	30 - 65 GHz	1.55:1 Max.
DC - 10 GHz	1.20:1 Max.						
10 - 30 GHz	1.40:1 Max						
30 - 65 GHz	1.55:1 Max.						
Input Power	1 Watts Avg. @ 25°C <i>Derated Linearly to 0.1 Watts at +100°C</i>						
Impedance	50 Ohms						
Operating Temp. Range	-55°C to +100°C						



Mechanical

Feature	Material
1.85mm Connectors	Passivated Stainless Steel
Conductors	Gold Plated Beryllium Copper
Barrel & Coupling Nut	Passivated Stainless Steel

Physical Dimensions

Model Number: TV650M-1W

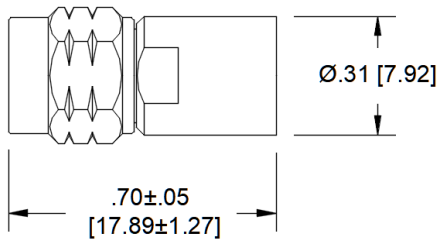

Model Number: TV650F-1W

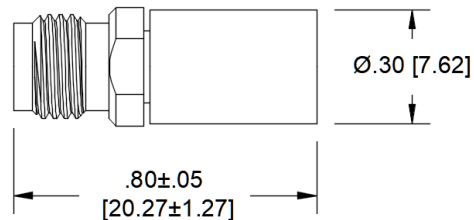

How to Order

TV650X- 1W



Dimensions in brackets [] are expressed in Millimeters and are for reference only.
Design Specifications are subject to change without notice.

REV B