

Termination, 1.85mm

Models: TV650F-1W, TV650M-1W

Features

- Millimeter Wave Termination
- Suitable for use in Military Applications
- Economically priced for Commercial Applications
- Mates with 1.85mm and 2.4mm Connectors

Technical Specifications

| Parameter | Value |
|-----------------------|---|
| Frequency Range | DC to 65 GHz |
| VSWR | |
| DC - 10 GHz | 1.20:1 Max. |
| 10 - 30 GHz | 1.40:1 Max |
| 30 - 65 GHz | 1.55:1 Max. |
| Input Power | 1 Watts Avg. @ 25°C <i>Derated Linearly to 0.1 Watts at +100°C</i> |
| Impedance | 50 Ohms |
| Operating Temp. Range | -55°C to +100°C |

Frequency Range: DC to 65 GHz
Power: 1 Watts



Mechanical

| Feature | Material |
|-----------------------|------------------------------|
| 1.85mm Connectors | Passivated Stainless Steel |
| Conductors | Gold Plated Beryllium Copper |
| Barrel & Coupling Nut | Passivated Stainless Steel |

Physical Dimensions

Model Number: TV650M-1W

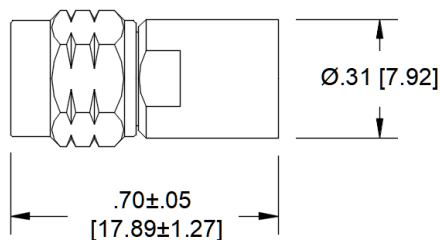

Model Number: TV650F-1W

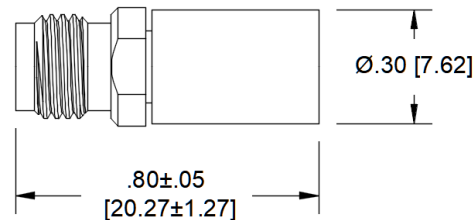

How to Order

TV650X- 1W

Base
 Model #
 M = Male
 F = Female

*Dimensions in brackets [] are expressed in Millimeters and are for reference only.
 Design Specifications are subject to change without notice.*

REV B