

Terminations SMA

up to 26.5 GHz
1 Watt

MODELS: TSXXXM, TSXXXF, TSXXXMC, TSXXXFC

Technical Specifications

Parameter	Value
<i>Electrical</i>	
Frequency Range	DC – 26.5 GHz
Standard Freq. Values	6, 18, 26.5 GHz
VSWR	DC – 4 GHz 1.05:1 max. 4 – 8 GHz 1.10:1 max. 8 – 12.4 GHz 1.15:1 max. 12.4 – 18 GHz 1.20:1 max. 18 – 26.5 GHz 1.35:1 max.
Input Power	1 Watt Average @ +25°C Derated linearity to 0 watt @ +125°C
Peak Power	1 kW max. (5µSec pulse, 0.05% duty cycle)
Impedance	50 Ohms
Operation Temp. Range	-65°C to +125°C
Temperature Coefficient	±250 ppm/°C

Parameter	Value
<i>Mechanical</i>	
SMA Connectors Mates with MIL-STD-348	Passive Stainless Steel**
Conductors	Gold Plated Beryllium Copper
Bead Chain	Passive Stainless Steel

**For gold plated connectors add /AU to the model number.

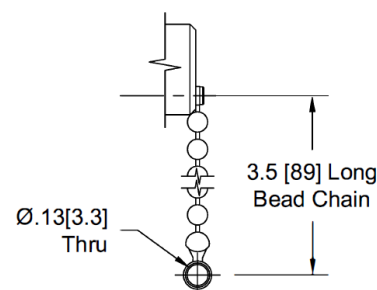

CHAIN DETAIL

Model Number TSXXXM

SMA Male Connector

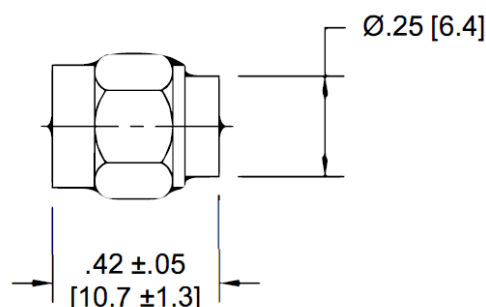

Model Number TSXXXF

SMA Female Connector

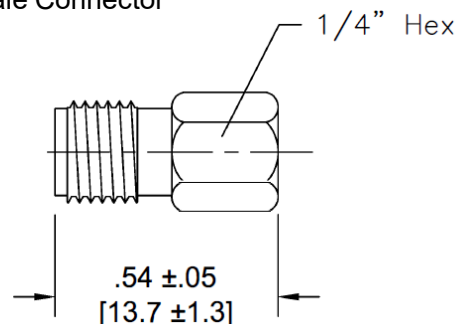

How To Order

Model #: TSXXXYZ/FF

Freq. Range. _____
 060 = DC-6 GHz
 180 = DC-18 GHz
 260 = 26.5 GHz

Connector Config. _____
 F = Female
 M = Male

Style _____
 = No chain
 C = Chain included

Finish _____
 = Passivated Conn.
 /AU = Gold-plated Conn

Order Examples

Model number: TS180MC
DC-18 GHz, SMA male, chain included

Model number: TN060F/AU
DC-6 GHz, SMA female, no chain, gold plate

Model number: TS260M
DC-26.5 GHz, SMA male, no chain

**Dimensions in brackets are expressed in millimeters and are for reference only.

sales@am.spectrumcontrol.com

Approved for Release: November 2024/Brown

Spectrum Control reserves the right to make changes to datasheets at any time without notice.