

Terminations

Type N

up to 18 GHz
2 Watts

MODELS: TNXXXM, TNXXXF, TNXXXMC, TNXXXFC

Technical Specifications

Parameter	Value
<i>Electrical</i>	
Frequency Range	DC – 18 GHz
Standard Freq. Values	6, 18 GHz
VSWR	DC – 4 GHz 1.10:1 max. 4 – 8 GHz 1.15:1 max. 8 – 12.4 GHz 1.20:1 max. 12.4 – 18 GHz 1.25:1 max.
Input Power	2 Watts Average @ +25°C Derated linearity to 1 watt @ +125°C
Peak Power	250 Watts max. (5μSec pulse, 0.05% duty cycle)
Impedance	50 Ohms
Operation Temp. Range	-65°C to +125°C
Temperature Coefficient	±250 ppm/°C

Parameter	Value
<i>Mechanical</i>	
Type N Connectors Mates with MIL-STD-348	Passive Stainless Steel
Conductors	Gold Plated Beryllium Copper
Bead Chain	Passive Stainless Steel

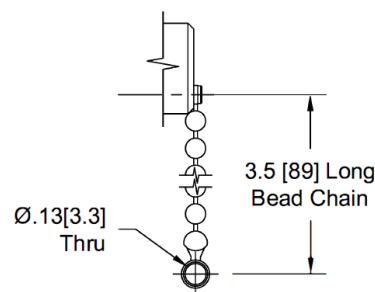

CHAIN DETAIL

Model Number TNXXXM

Type N Male Connector

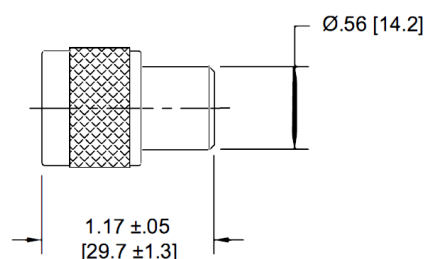

Model Number TNXXXF

Type N Female Connector

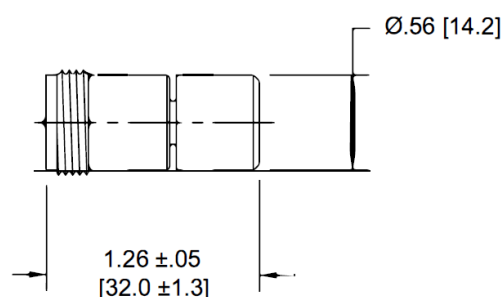

How To Order

Model #: **TNXXXYZ**

Freq. Range

060 = DC-6 GHz

180 = DC-18 GHz

Connector Config.

F = Female

M = Male

Style

= No chain

C = Chain included

Order Examples

Model number: TN180MC

DC-18 GHz, Type N male, chain included

Model number: TN060F

DC-6 GHz, Type N female, no chain

**Dimensions in brackets are expressed in millimeters and are for reference only.

sales@am.spectrumcontrol.com

Approved for Release: November 2024/Brown

Spectrum Control reserves the right to make changes to datasheets at any time without notice.