

Technical Specifications

Parameter	Value
<i>Electrical</i>	
Frequency Range	DC – 34 GHz
VSWR	1.25:1 max.
Impedance	50 Ohms
Operation Temp. Range	-65°C to +85°C

Parameter	Value
<i>Mechanical</i>	
2.9mm Connectors Mates both mechanically and electrically with all SMA, 3.5mm and K* series connectors.	Passivated Stainless Steel
3.5mm Connectors Mates both mechanically and electrically with all SMA, 2.9mm and K* series connectors.	Passivated Stainless Steel
Conductors	Gold Plated Beryllium Copper

*K is a trademark of Anritsu Corp.

Model Number AA-5266

2.9mm Female / 3.5mm Female

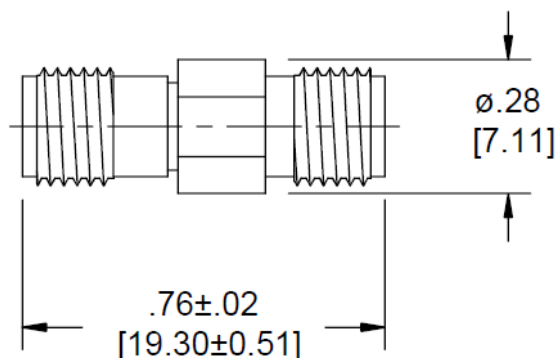

Model Number AA-5267

2.9mm Female / 3.5mm Male

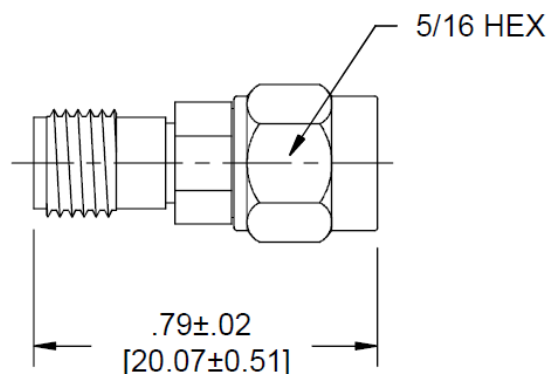

Model Number AA-5268

2.9mm Male / 3.5mm Female

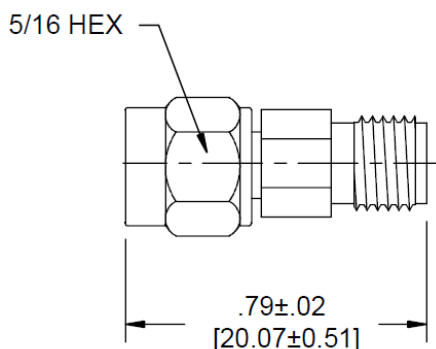

Model Number AA-5269

2.9mm Male / 3.5mm Male

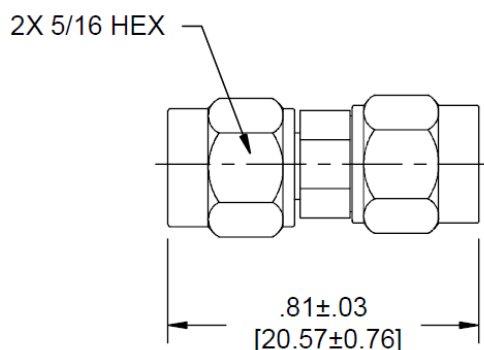

**Dimensions in brackets are expressed in millimeters and are for reference only.

sales@am.spectrumcontrol.com

Approved for Release: November 2024/Brown

Spectrum Control reserves the right to make changes to datasheets at any time without notice.