

DC Block - Inner Only

25 kHz – 20 GHz

MODEL: 8315

Technical Specifications

Parameter	Value
<i>Electrical</i>	
Frequency Range	25 kHz – 20 GHz
VSWR	1.35:1 typ. (1.50:1 max.)
Impedance	50 Ohms
Insertion Loss	0.5 dB typ. (0.75 dB max.)
Voltage Rating	100 Volts max. DC
Operation Temp. Range	-65°C to +125°C
Capacitance	470 nF

Parameter	Value
<i>Mechanical</i>	
SMA Female Connector Mates with MIL-STD-348	Passivated Stainless Steel
2.9mm Male Connector Mate both mechanically & electrically with all SMA, K* & 3.5mm connectors	Passivated Stainless Steel
Conductors	Gold Plated Beryllium Copper

*K is a trademark of Anritsu/Wiltron Corp.

Model Number: 8315

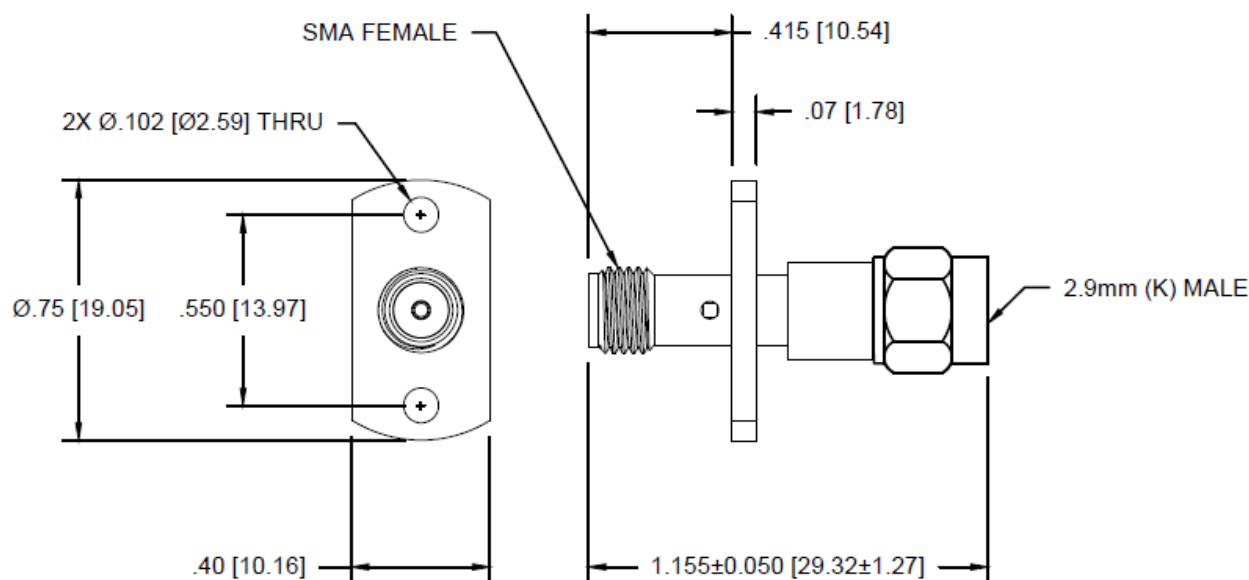

***Dimensions in brackets are expressed in millimeters and are for reference only.

sales@am.spectrumcontrol.com

Approved for Release: March 2025/Brown

Spectrum Control reserves the right to make changes to datasheets at any time without notice.