

# DC Blocks

## 2.9mm

**7 kHz – 26.5 GHz**  
**Inner Only**

MODELS: 8060A, 8063A, 8066A

### Technical Specifications

Parameter	Value
<i>Electrical</i>	
Frequency Range and Typ. -3 dB, Bandwidth	7 kHz – 26.5 GHz
VSWR	
250 kHz – 18 GHz	1.35:1 max.
18 GHz – 26.5 GHz	1.50:1 max.
Typ. Risetime	<9 picoSeconds
Capacitance Nominal	100 nanoFarads
Impedance	50 Ohms
Insertion Loss	
250 kHz – 18 GHz	0.5 dB max.
18 GHz – 26.5 GHz	0.75 dB max.
Voltage Rating	75 Volts max.
Operation Temp. Range	-35°C to +85°C

Parameter	Value
<i>Mechanical</i>	
2.9mm Connectors Mates both mechanically and electrically with SMA, SMK, 3.5mm and K* series connectors	Passivated Stainless Steel
Conductors	Gold Plated Beryllium Copper
Housings	Passivated Stainless Steel

\*K is a trademark of Anritsu Corp.

### Model Number: 8060A

#### 2.9mm Male / Female

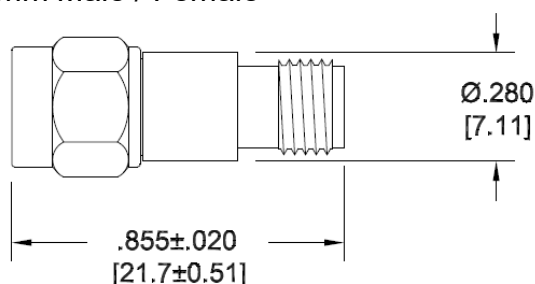

### Model Number: 8063A

#### 2.9mm Female / Female

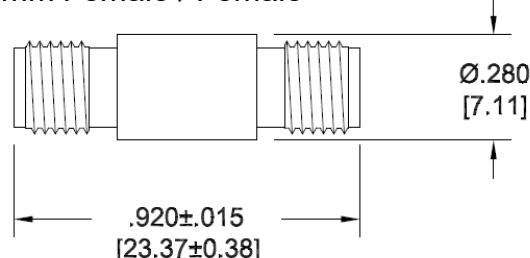

### Model Number: 8066A

#### 2.9mm Male / Male

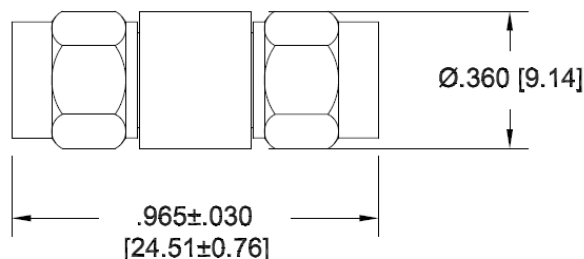

\*\*Dimensions in brackets are expressed in millimeters and are for reference only.