

# DC Blocks SMA

**10 MHz – 18 GHz  
Inner Only**

MODELS: AA-8055, 8055H

## Technical Specifications

Parameter	Value
<i>Electrical</i>	
Frequency Range	10 MHz – 18 GHz
VSWR	1.35:1 max.
Impedance	50 Ohms
Insertion Loss	0.5 dB
Voltage Rating	200 Volts
Operation Temp. Range	-65°C to +125°C

Parameter	Value
<i>Mechanical</i>	
Connectors Mates with MIL-STD-348	Passivated Stainless Steel
Conductors	Gold Plated Beryllium Copper

### Model Number: AA-8055 Male / Female Connectors

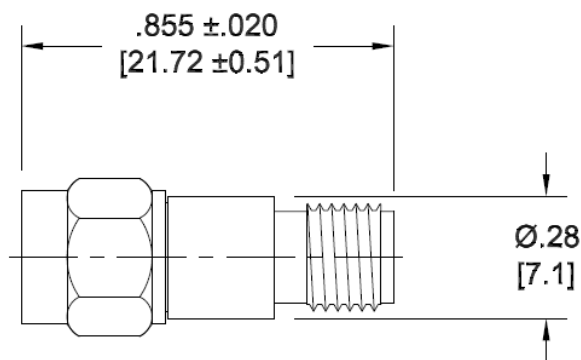

### Model Number: 8055H Male / Female Connectors

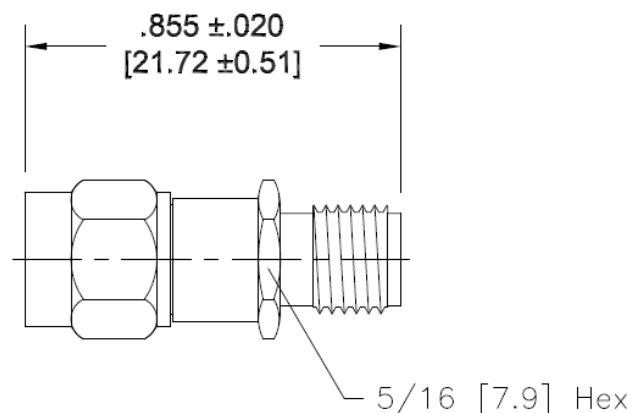

\*\*Dimensions in brackets are expressed in millimeters and

sales@am.spectrumcontrol.com

Approved for Release: November 2024/Brown

Spectrum Control reserves the right to make changes to datasheets at any time without notice.