

## Technical Specifications

Parameter	Value
<i>Electrical</i>	
Frequency Range	DC – 26.5 GHz
VSWR	DC – 18 GHz 1.15:1 max. 18 – 26.5 GHz 1.25:1 max.
Impedance	50 Ohms
Operation Temp. Range	-65°C to +125°C

Parameter	Value
<i>Mechanical</i>	
Connectors Mates both mechanically and electrically with all SMA, K* and 3.5mm series connectors.	Passivated Stainless Steel
Conductors	Gold Plated Beryllium Copper

\*K is a trademark of Wiltron Corp.

## Model Number 5338 Female/Female Connector

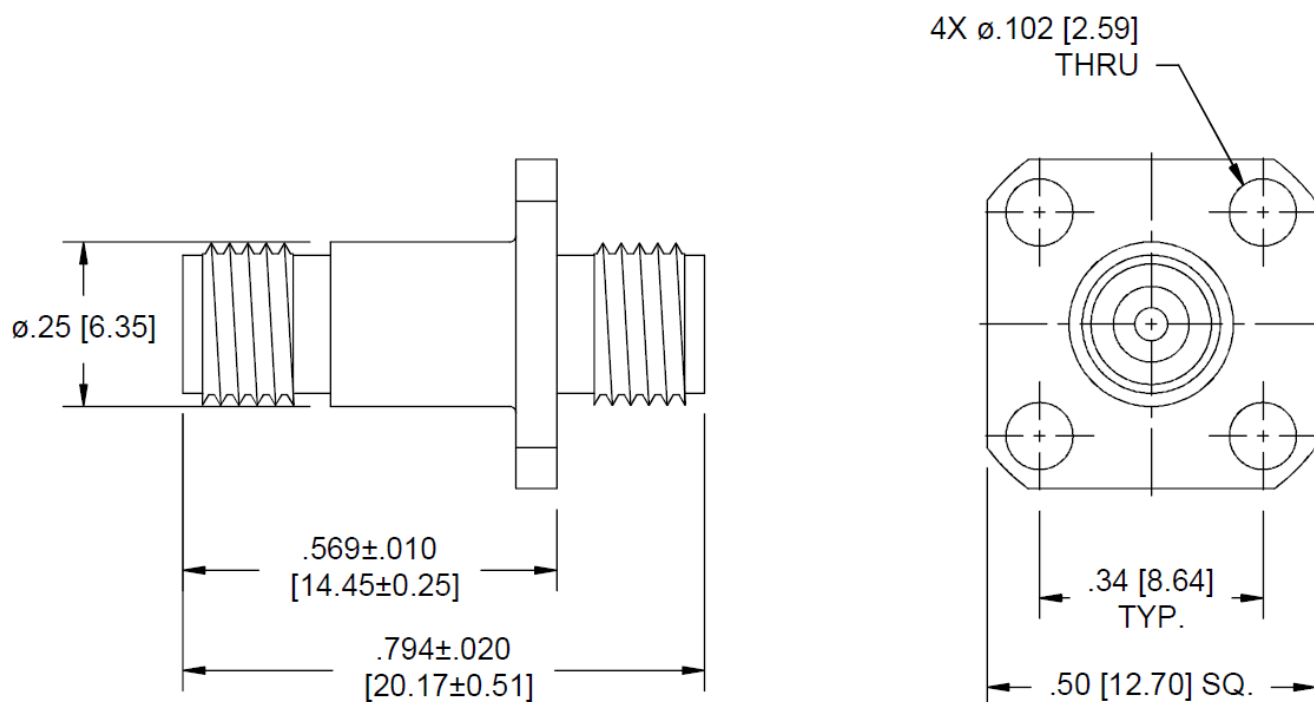

\*\*Dimensions in brackets are expressed in millimeters and are for reference only.

sales@am.spectrumcontrol.com

Approved for Release: November 2024/Brown

Spectrum Control reserves the right to make changes to datasheets at any time without notice.