

Adapters, In-Series SMA, Bulkhead Mount

MODELS: AA-5205, 5205/AU

Technical Specifications

Parameter	Value
<i>Electrical</i>	
Frequency Range	DC – 18 GHz
VSWR	DC – 4 GHz 1.05:1 max. 4 – 8 GHz 1.10:1 max. 8 – 18 1.15:1 max.
Impedance	50 Ohms
Operation Temp. Range	-55°C to +125°C
<i>Mechanical</i>	
Connectors Mates with MIL-STD-348	See below
Conductors	Gold Plated Beryllium Copper
Nut & Washer	Passivated Stainless Steel

Model Number AA-5205

Connectors: Passivated Stainless Steel

Model Number 5205/AU

Connectors: Gold Plated Stainless Steel

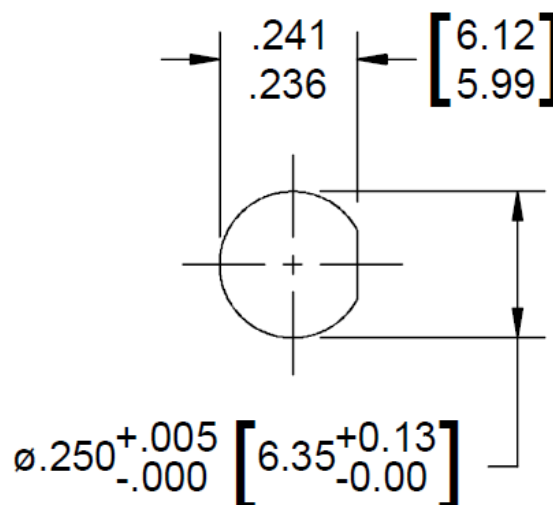

Recommended Mounting Hole

**Dimensions in brackets are expressed in millimeters and are for reference only.

