

# Adapters, Between Series 2.4mm / 2.9mm

**DC – 40 GHz**

MODELS: AA-5151, AA-5152, AA-5153, AA-5154

## Technical Specifications

Parameter	Value
<i>Electrical</i>	
Frequency Range	DC – 40 GHz
VSWR	DC – 18 GHz 1.10:1 max. 18 – 26.5 GHz 1.20:1 max. 26.5 – 40 1.30:1 max.
Impedance	50 Ohms
Operation Temp. Range	-65°C to +125°C

Parameter	Value
<i>Mechanical</i>	
2.4mm Connectors Mates with MIL-STD-348	Passivated Stainless Steel
2.9mm Connectors Mates both mechanically and electrically with all SMA, K* and 3.5mm series connectors.	Passivated Stainless Steel
Conductors	Gold Plated Beryllium Copper

\*K is a trademark of Wiltron Corp.

### Model Number AA-5154

2.4mm Male / 2.9mm Male

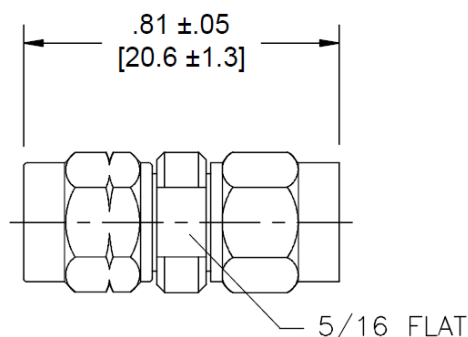

### Model Number AA-5153

2.4mm Male / 2.9mm Female

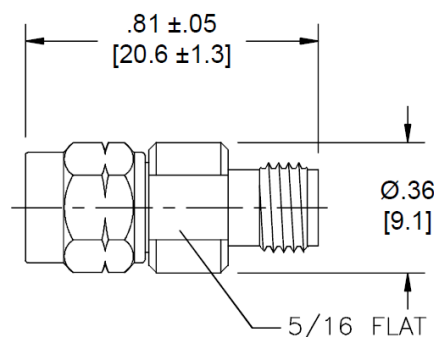

### Model Number AA-5152

2.4mm Female / 2.9mm Male

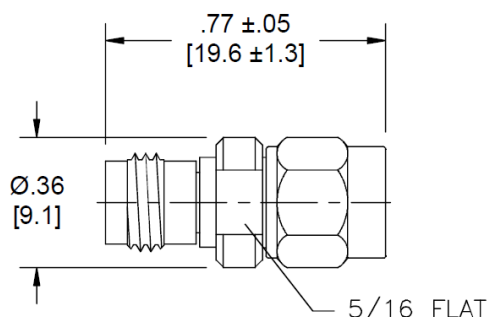

### Model Number AA-5151

2.4mm Female / 2.9mm Female

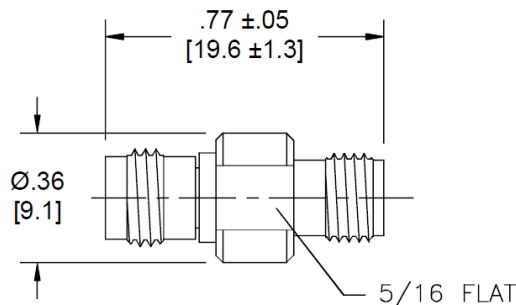

\*\*Dimensions in brackets are expressed in millimeters and are for reference only.

sales@am.spectrumcontrol.com

Approved for Release: November 2024/Brown

Spectrum Control reserves the right to make changes to datasheets at any time without notice.