

Technical Specifications

Parameter	Value
<i>Electrical</i>	
Frequency Range	DC – 34 GHz
VSWR	1.25:1 max.
Impedance	50 Ohms
Operation Temp. Range	-65°C to +125°C

Parameter	Value
<i>Mechanical</i>	
3.5mm Connectors Mates both mechanically and electrically with SMA, K* connectors	Passivated Stainless Steel
Conductors	Gold Plated Beryllium Copper

*K is a trademark of Anritsu Corp.

Model Number 5084

Male / Female Connectors

5/16 HEX

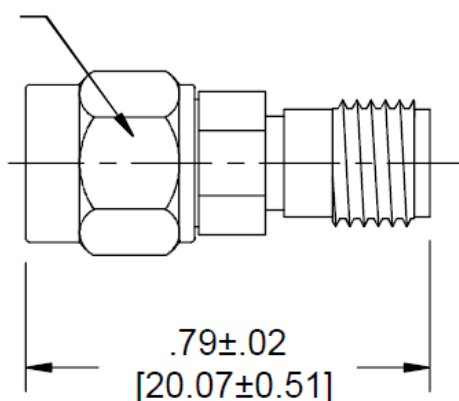

Model Number 5085

Male / Male Connectors

2X 5/16 HEX

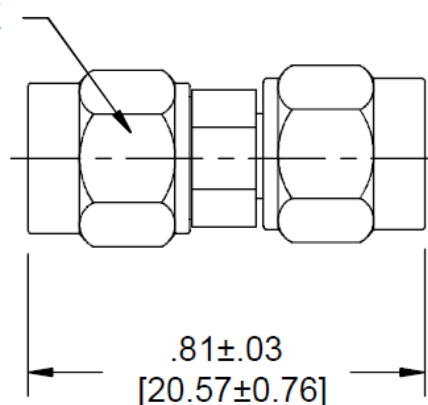

Model Number 5086

Female / Female Connectors

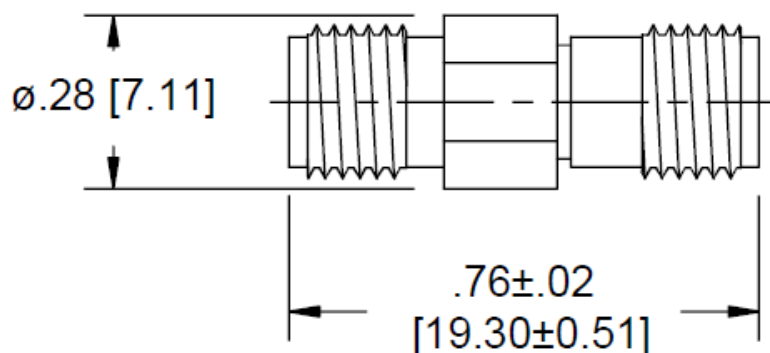

**Dimensions in brackets are expressed in millimeters and are for reference only.

sales@am.spectrumcontrol.com

Approved for Release: November 2024/Brown

Spectrum Control reserves the right to make changes to datasheets at any time without notice.