

Terminations SMA, Reverse Polarity

**DC – 6 GHz
1 Watt**

MODELS: 3206-SMARP

Technical Specifications

Parameter	Value
<i>Electrical</i>	
Frequency Range	DC – 6 GHz
VSWR	DC – 3 GHz 1.15:1 max. 3 – 6 GHz 1.20:1 max.
Input Power	1 Watt Average @ 25°C <i>Derated linearity to 0.1 watt @ +125°C</i>
Impedance	50 Ohms
Operation Temp. Range	-55°C to +125°C

Parameter	Value
<i>Mechanical</i>	
Reverse Polarity SMA Male <i>Mates with reverse polarity female</i>	White Bronze Plated Brass
Conductor	Gold Plated Beryllium Copper
Coupling Nut	White Bronze Plated Brass

Model Number 3206-SMARP

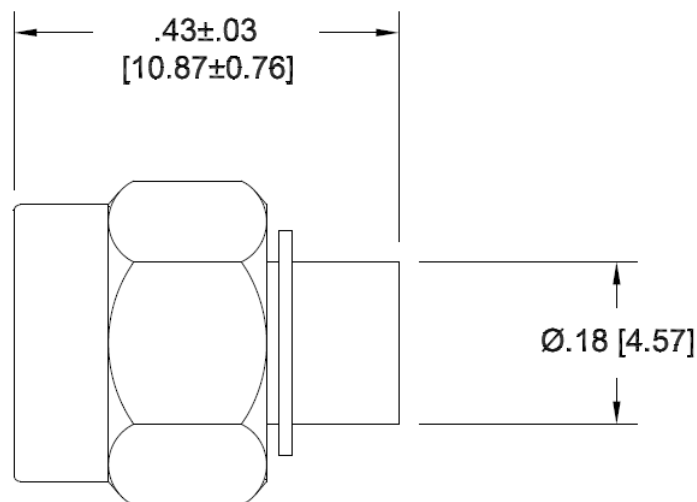

**Dimensions in brackets are expressed in millimeters and are for reference only.

sales@am.spectrumcontrol.com

Approved for Release: April 2025/Brown

Spectrum Control reserves the right to make changes to datasheets at any time without notice.