

# Terminations

## 2.9mm

**up to 18 GHz**  
**5 Watts**

MODEL: 1443-2

### Technical Specifications

Parameter	Value
<i>Electrical</i>	
Frequency Range	DC – 18 GHz
VSWR	1.20:1 max.
Input Power	5 Watts Average @ 25°C Derated linearity to 0.5 watt @ +125°C
Peak Power	0.5 kW max. (5µSec pulse, 0.5% duty cycle)
Impedance	50 Ohms
Operation Temp. Range	-55°C to +125°C

Parameter	Value
<i>Mechanical</i>	
2.9mm Connectors <i>Mates both mechanically and electrically with all SMA, 3.5mm and 2.9mm connectors per MIL-C-39012.</i>	Passive Stainless Steel
Contacts	Gold Plated Beryllium Copper
Housing	Anodized Aluminum (Black)

### Model Number 1443-2

2.92mm Male Connector

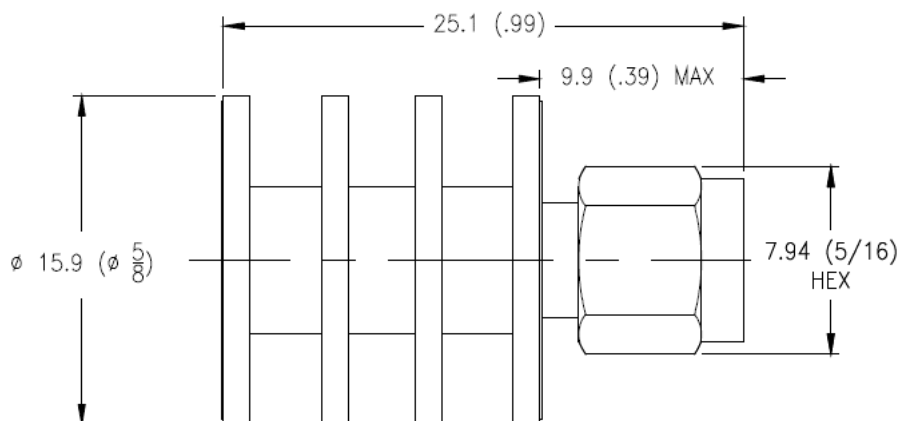

\*\*Dimensions in brackets are expressed in millimeters and are for reference only.

sales@am.spectrumcontrol.com

Approved for Release: April 2025/Brown

Spectrum Control reserves the right to make changes to datasheets at any time without notice.