

# Model M1419

## Medium Power, Ruggedized SMA Connectors

# DC to 18.0 GHz

## 10 Watts

 **RoHS**

### Features

- /// **Miniature Size and Lightweight** - All models are approximately 1.6 inches long, and weigh less than 14 grams with male connector.
- /// **Quality Injection Molded Connector.**

### Specifications

**NOMINAL IMPEDANCE:** 50 Ω

**FREQUENCY RANGE:** DC to 18.0 GHz

#### MAXIMUM SWR:

Frequency (GHz)	SWR
DC - 8	1.20
8 - 12.4	1.30
12.4 - 18	1.35

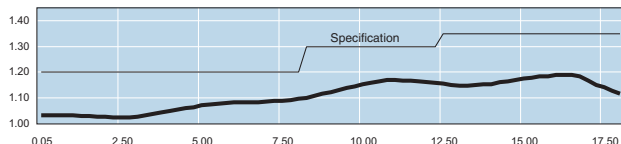

Typical M1419 SWR Performance

**POWER RATING:** 10 watts **average (mounted horizontally)** @ 25°C ambient temperature, derated linearly to 0 watts @ 125°C. 1 kilowatt **peak** (5 μsec pulse width; 0.5% duty cycle).

**TEMPERATURE RANGE:** -55°C to +125°C

**TEST DATA:** Swept data plots of SWR from 50 MHz to 18 GHz.

**CONNECTOR:** SMA connector per MIL-STD-348 interface dimensions - mate nondestructively with MIL-C-39012 connector. Male connector.

**CONSTRUCTION:** Black, finned aluminum body, stainless steel connector; gold plated beryllium copper contacts.

**WEIGHT:** 14 g (0.49 oz)

#### PHYSICAL DIMENSIONS:

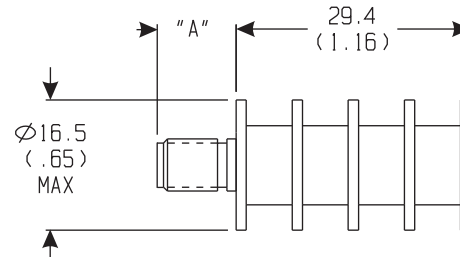

Model #	DIM A	Connector Type
M1419	11.2 (0.44)	SMA male

**NOTE:** All dimensions are given in mm (inches) and are maximum, unless otherwise specified.